



To J.B. Fox, Esq.,
Register of Deeds
Ellis County, Mo.

The Board of County Commissioners of Ellis County, Kansas, made an order on August 2^d 1904, vacating all of the streets and alleys in that part of the Walker Town & Improvement Company's Addition to the original townsite of Walker, lying south of the Union Pacific Railroad Right-of-way in Ellis County, as named in the following "Public Notice"

Notice.
To Whom it May Concern:
Notice is hereby given that at the next regular meeting of the Board of County Commissioners of Ellis County, Kansas, the undersigned will present his petition to said Board, praying that all the streets and alleys in that part of the Walker Town & Improvement Company's Addition to the original townsite of Walker, south of the Union Pacific Railroad right of way, in said county, be vacated and cancelled. All persons opposed to the granting of such petition will govern themselves accordingly.
NICK DREILING, Petitioner.
Dated June 6th 1904.

Filed August 15th 1904
J.B. Fox
Register of Deeds

M.O. Dinges
County Clerk

For Vacation Proceedings on Certain Portions of the Plat of the Townsite of the Walker Town and Improvement Company's Addition to the Town of Walker, Ellis County, Kansas, See Books "11" of Miscellaneous Record on page "312".
In the Office of the Register of Deeds.

Nick Dreiling

John C. Adams
Jan 28 1912

DREILING FIRST ADDITION WALKER

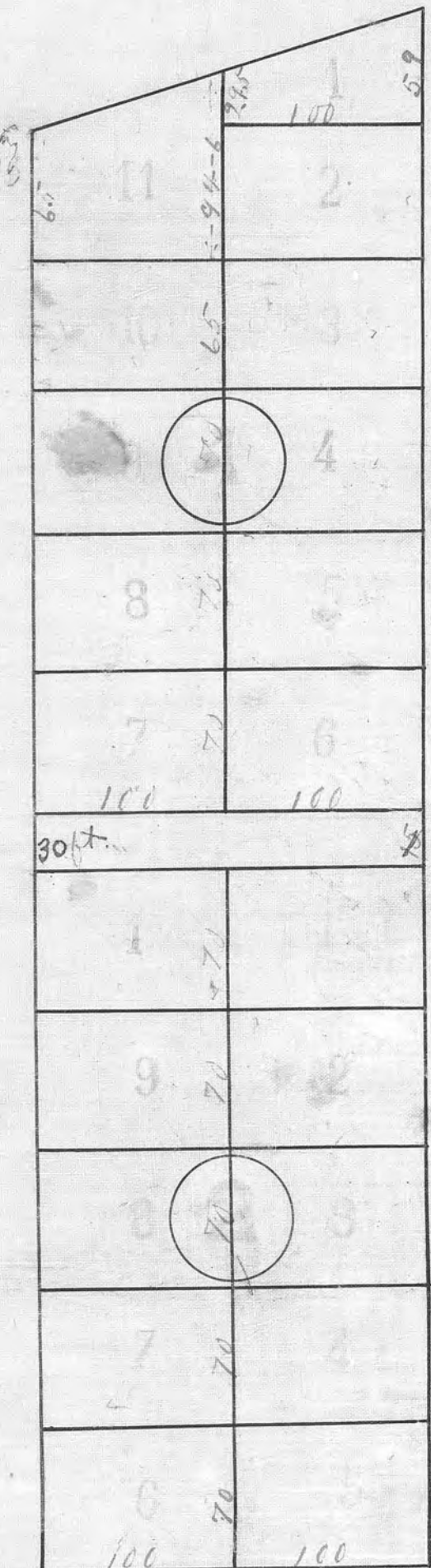
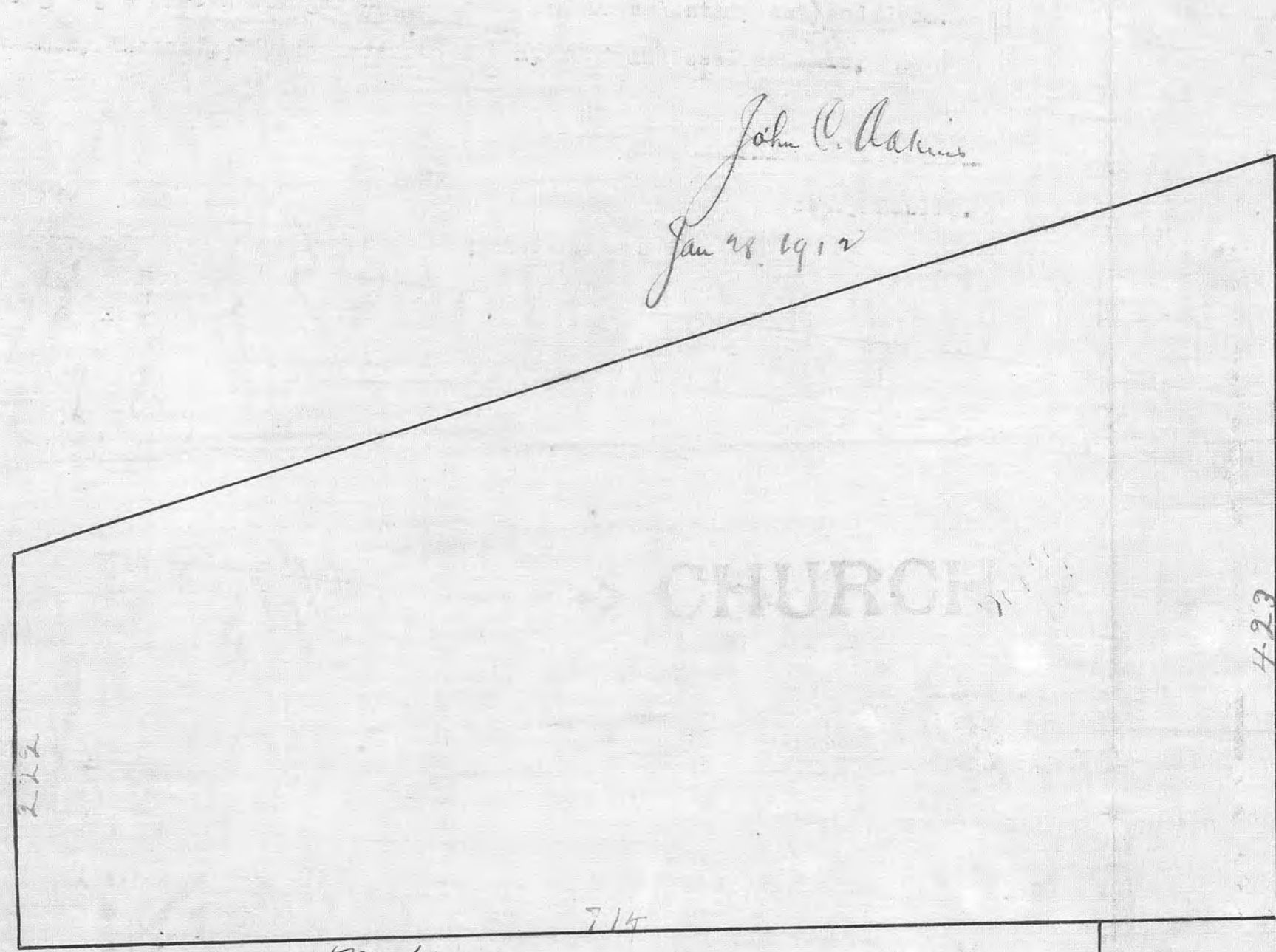

Dreiling's First Addition to the Town of Walker as shown on attached plat, is located on Secs 2 & 3 in Tps. 14 Rg 16, in Ellis Co. Kans.

Said Addition consists of blocks one (1) & two (2) and a plot of ground on which the Catholic Church is located. The dimensions of said plat are shown in attached diagram.

Block one (1) contains eleven (11) lots the dimensions of said block & lots being according to plat attached.

Block two (2), contains ten (10) lots the dimensions of which are set forth in plat attached.

Blocks one (1) & two (2) are separated by an alley running east & west said alley being fifteen (15) feet wide.

Blocks one (1) & two (2) are separated from church plat by a street running north & south, said street being (66) sixty-six feet wide.

On the south side of Church plat are lots one (1) & two (2) being of the dimensions as described in the plat.

The section cor. between Sec. 2 & 3 and between Tps. 13 & 14 Rg 16 in said County is 1668 feet due north of a point 10ft west of the north-west cor. of lot 11 in Blk 1, the section line between sections 2 & 3 being 10ft west of the west line of Blks 1 & 2.

In The District Court of Ellis County, Kansas,
Mike Wittman, Mary Fiesher,
Andrew Mermis and Anton Pidel
Plaintiffs
vs.
Joe Dreiling
Defendant.
No. 1136.

WALKER
TPS 14 RG 16W 6 PM

Scale 80ft = 1 in
Justice Walter

This plat filed April. 16-1904 at 2:00 P.M.

A. Schueler Jr. Register
C. J. Ash, Deputy.