

39 46

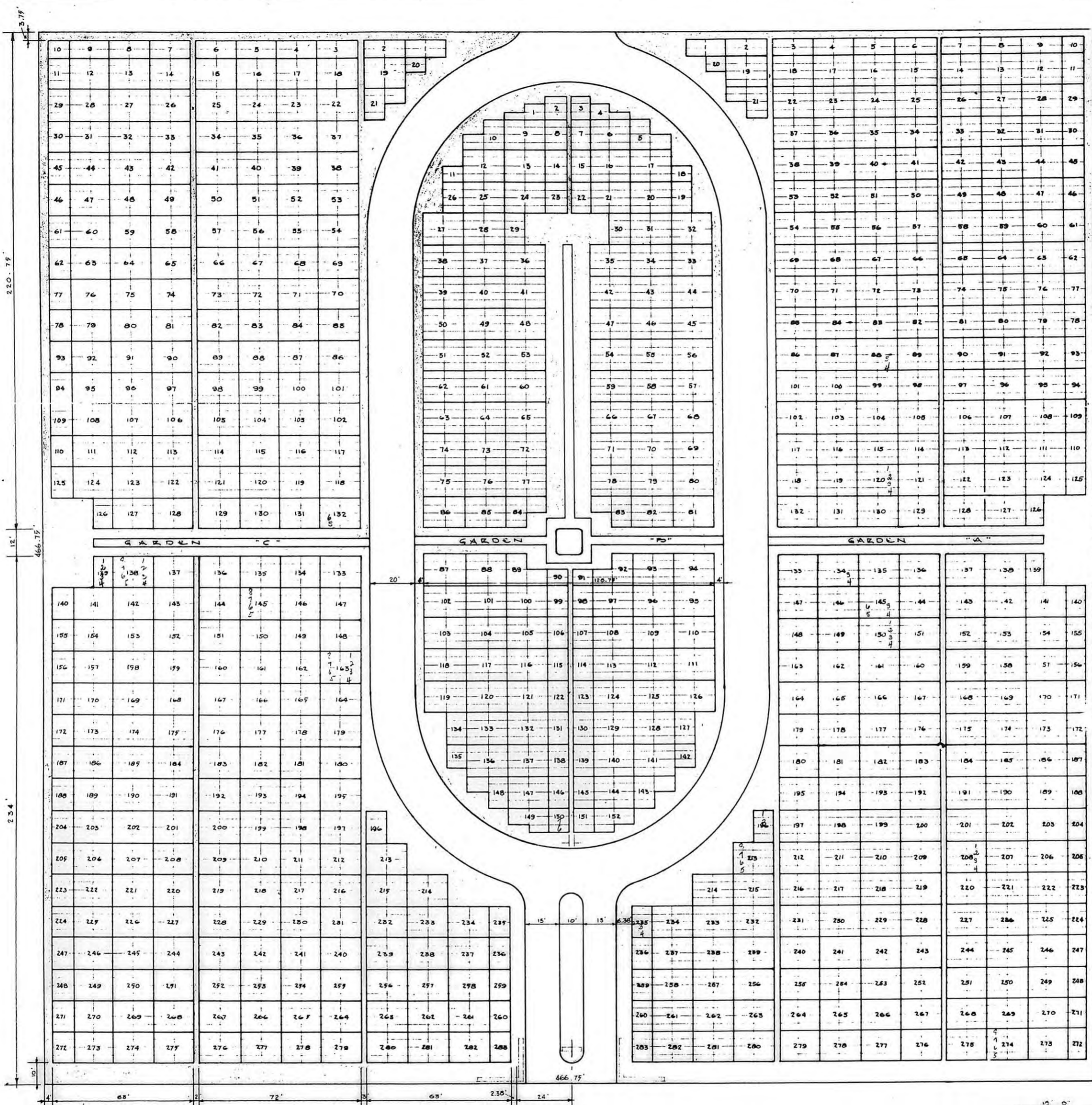

STATE OF KANSAS
 ELLIS COUNTY
 This instrument was filed for record

28 1956
 10 o'clock M recorded in
 of 1956 page 566
 1274 Subdivision
 Form L.S.L.A.P. 21 1955

THIS IS A HALF-SIZE PHOTOGRAPHIC REPRODUCTION OF THE OFFICIAL INSTRUMENT
 (RECORDED PLAT).

THIS REPRODUCTION WAS MADE BY BUCHER & WILLIS, CONSULTING ENGINEERS,
 PLANNERS & ARCHITECTS IN JUNE 1979



15	0
8	1
7	2
6	3
5	4
4	5

TYPICAL LOT PLAN -
 SCALE 1" = 10' 0"

See & record in spec. book 4

FT. HAYS MEMORIAL GARDENS

prepared for

FT. HAYS MEMORIAL GARDENS, INC., LOCATED AT HAYS KANS. IN ELLIS COUNTY ON OLD U. S. HIGHWAY 40

prepared by

EVANS - RONDEAU and Associates GREAT PLAIN, KANS. MARCH 15, 1956