

Know all men by these presents, that I, C. M. Yost, the undersigned, of Ellis County, State of Kansas, being the owner of lots numbered Eighteen (18) and Nineteen (19) Lebold, Allen & Co.'s Addition to the city of Hays, County of Ellis, State of Kansas, have caused the same to be surveyed and replatted for records as an addition to city of Hays to be named and known as Laurel Hill Addition to the city of Hays in accordance with the certificate of survey and the plat of the same, both of which well hereunto annexed and duly didicate the said alleys and public grounds as appears upon said plat to the public use for the purposes indicated and for no other purpose. In testimony whereof I have hereunto set my hand this 6th day of May A.D. 1887.

Laurel Hill

State of Kansas }
County of Ellis }
Be it remembered that on this 10th day of May A.D. 1887 before me Chas. J. Rocher, a Notary Public, in and for said County and State of Kansas, came C. M. Yost known to me to be the same person who executed the foregoing statement and dedicated the accompanying plat of Laurel Hill Addition to the city of Hays, and acknowledged that he executed the same for the purposes therein expressed. In testimony whereof, I have hereunto set my hand and affixed my Notarial seal, the day and year last above written.

Chas. J. Rocher, (Notary Public)
Notary Public com. ex. 11-13-90



For Ordinance
Opening Alley
See BK 154 Page 96

Sixth Ave.

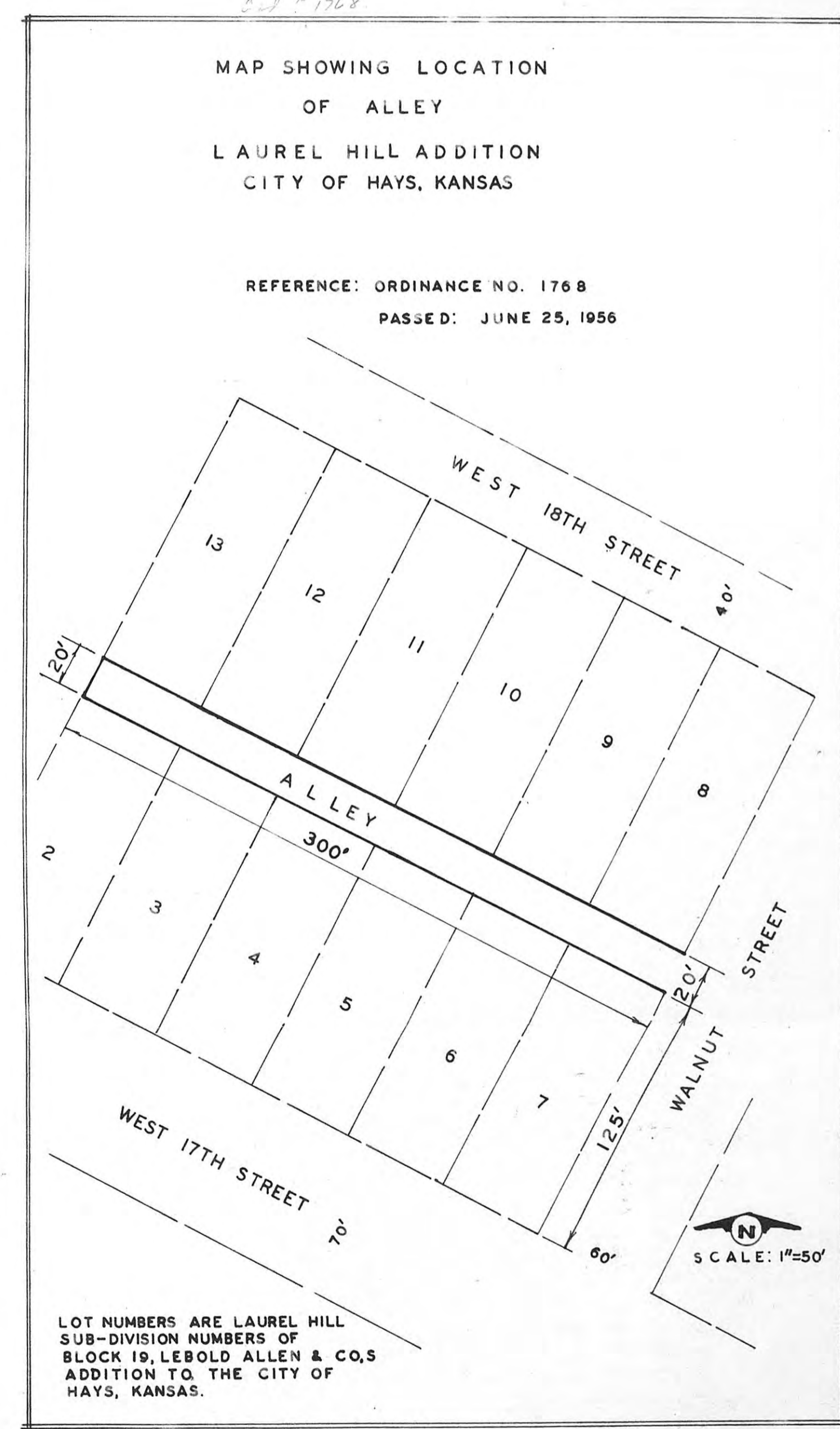

LOT NUMBERS ARE LAUREL HILL SUB-DIVISION NUMBERS OF BLOCK 19, LEBOLD ALLEN & CO.'S ADDITION TO THE CITY OF HAYS, KANSAS.