

Re- Subdivision of
Block 48
in Lebold Allen & Co's Addition to
The City of Hays Kansas.

State of Kansas }
County of Ellis } ss.

I, C. F. McLain, owner and proprietor of Block 48 in
Lebold, Allen & Co's Addition to the City of Hays, Kansas, do hereby
sub-divide said Block 48 as follows:

Into eighteen (18) lots, each 125 by 50 feet in size, with an
alley 20 feet in width running east and west through said block,
according to the plat attached hereto and made a part hereof and do
hereby dedicate to the public the use of said alley so laid out
through said block.

C. F. McLain

On this 12 day of March AD 1909, before me the undersigned,
personally came C. F. McLain to me well known to be the proprietor of Block 48
in Lebold Allen & Co's Addition to the City of Hays Kansas, at the time the
annexed plat thereof was surveyed, and acknowledged the annexed plat to
be a true and correct plat of his re-subdivision of said Block 48

A. E. McLain Justice of the Peace
of Big Creek T. Ellis Co. Kas.

In testimony whereof I have hereunto set my hand and affixed my
official seal at my office in Hays Kansas, this _____ day of March
AD 1909,

A. E. McLain Justice of the Peace
of Big Creek T. Ellis Co. Kas.

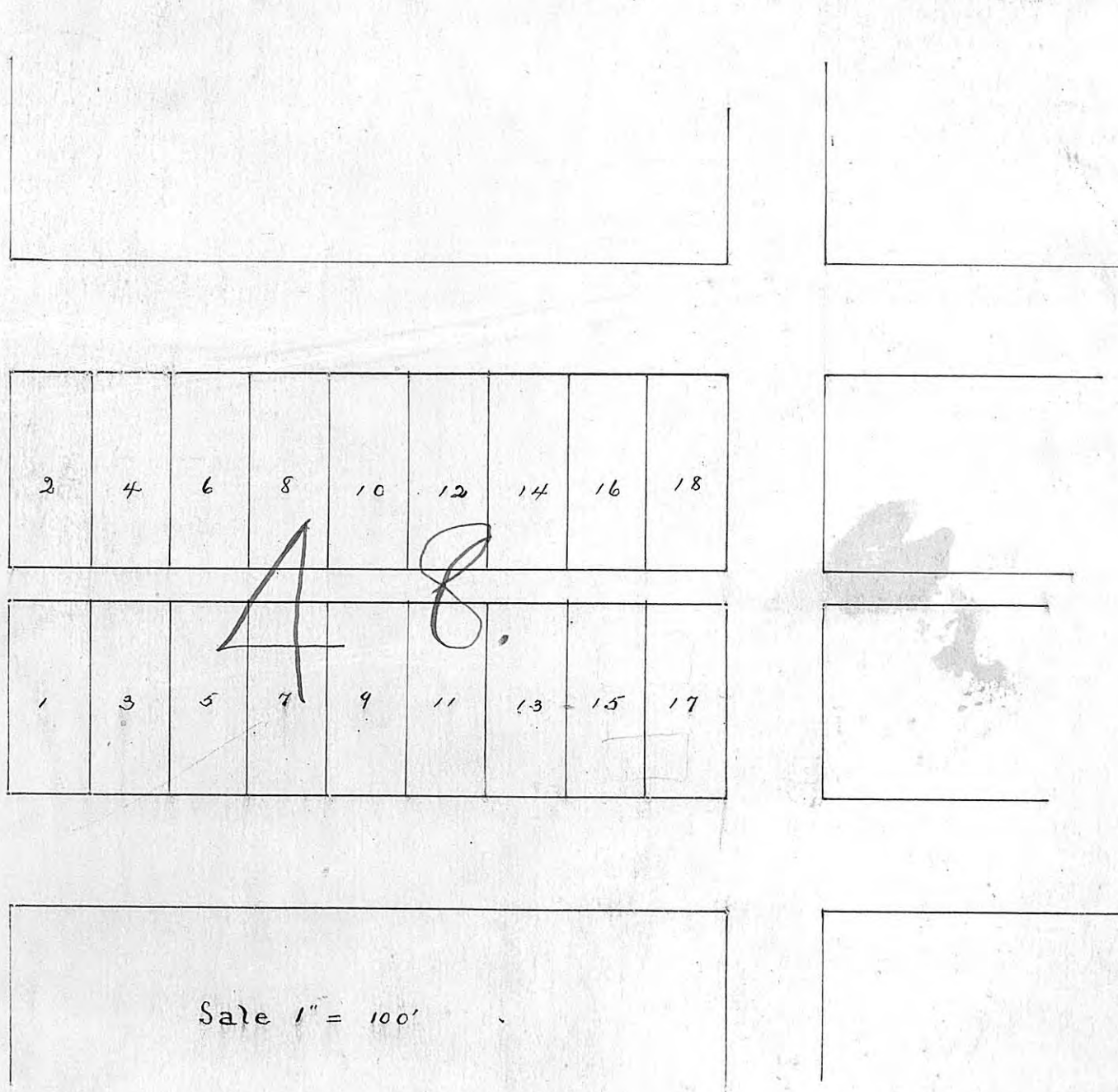
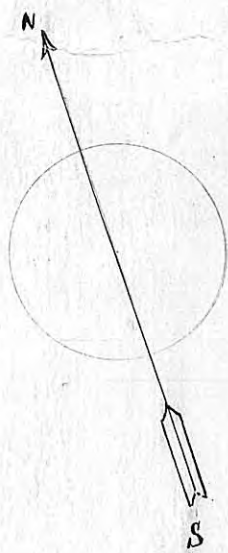

March 13, 1909 at 10 O'clock A.M.

A. Schuler Jr.

Register of Deeds.