

TOWN PLAT of MUNJOR

ELLIS COUNTY KANSAS

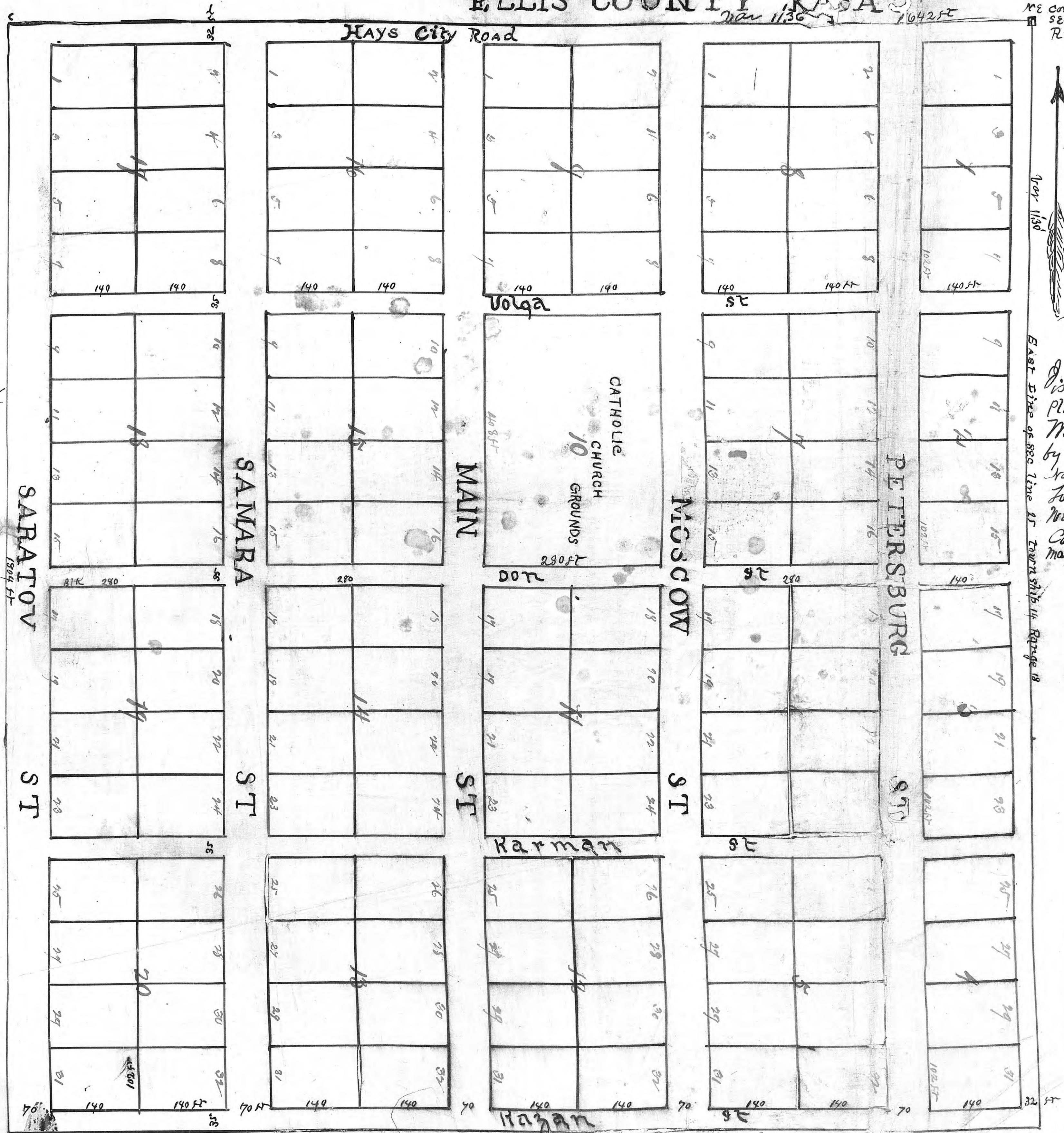

M-5

I hereby certify this to be a true copy of the original town plat of Munjor recorded this 20th day of June A.D. 1882

Eli. P. Register

NE Corner of Sec 25 Township 14 Range 18 W of 6 P.M.

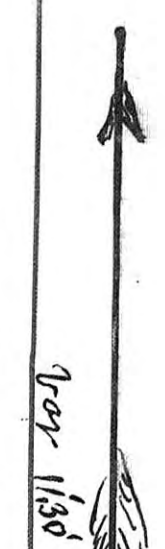

State of Kansas
Ellis County
I hereby certify that this is a true and correct Plat of the Town of Munjor as surveyed by me located on the North East 1/4 of Sec 25 Township 14 Range 18 West of 6th Ellis County Kansas
May 11 1882
C. R. Wolfe
County Surveyor
Ellis County
Kansas

State of Kansas }
Ellis County } ss.

The Town of Munjor as laid out as per this plat hereunto annexed on the North East Quarter of Section 25 Township 14 Range 18 West in the County of Ellis & State of Kansas. And we the Undersigned Directors and Managers of said Town do hereby acknowledge the said plat as laid out by us and hereby dedicate the streets as laid out upon said plat to the public use as required and provided by the laws of the State of Kansas.

Given under our hands and the Seal of said Corporation this 11th day of October 1882.
Conrad Leiker Mayor
Peter Leiker
John Glick
Joseph J. Leiker

I, John C. Atkins Notary Public for the County of Ellis & State of Kansas do hereby certify that this day personally appeared before me Conrad Leiker, Matthias Rahr, Peter Leiker, John Glick and Joseph J. Leiker and acknowledged the plat above to the dedication of streets in the town of Munjor Ellis County Kansas to the public use as then free and well used.

Witness my hand and Notary Seal at Hays City this 11th day of October 1882

John C. Atkins
Notary Public
Commission expires Feb 5. 1884

Scale 100 ft to the inch
Drawn by C. R. Wolfe
County Surveyor
Ellis County
May 11 1882

DEDICATION FOR PUBLIC PURPOSES
The East Ten Feet (10') of Lot Fifteen (15) Sec. 25, East 10' of West 27, Block 5, Town of Munjor.
BOOK: 280 PAGE: 213
Back: 281 Pg: 95