

- NOTES**
- CONDENSER PADS MARKED MK1 TO BE 3' X 4' X 4" WITH 6-6/10-10 MESH, BY GENERAL CONTRACTOR.
 - 12" X 12" X 4" CONCRETE PAD "2" AT SCREEN LINE CLEANOUT, BY GENERAL CONTRACTOR.

STATE OF KANSAS }
 ELLIS COUNTY }
 This instrument was filed for record
 AUG 25 1983
Ralph John Keller M. recorded in
 8:00 clock 7:31
 Fees - 7.00 Register of Deeds

OAK PARK A CONDOMINIUM

Owner: WHEEL ENTERPRISES

Location: HAYS, KANSAS

RALPH JOHN KELLER Architect sheet
 413 N. Pomeroy Hill City, Kansas
 date: 7-12-83 job no. 83-05-04 of 2 34

FLOOR PLAN
 scale 3/32" = 1' - 0"

BENCH MARK, 4 SQUARE CUT ON EAST SIDE OF PUMP STATION ELEVATION 2016.91'

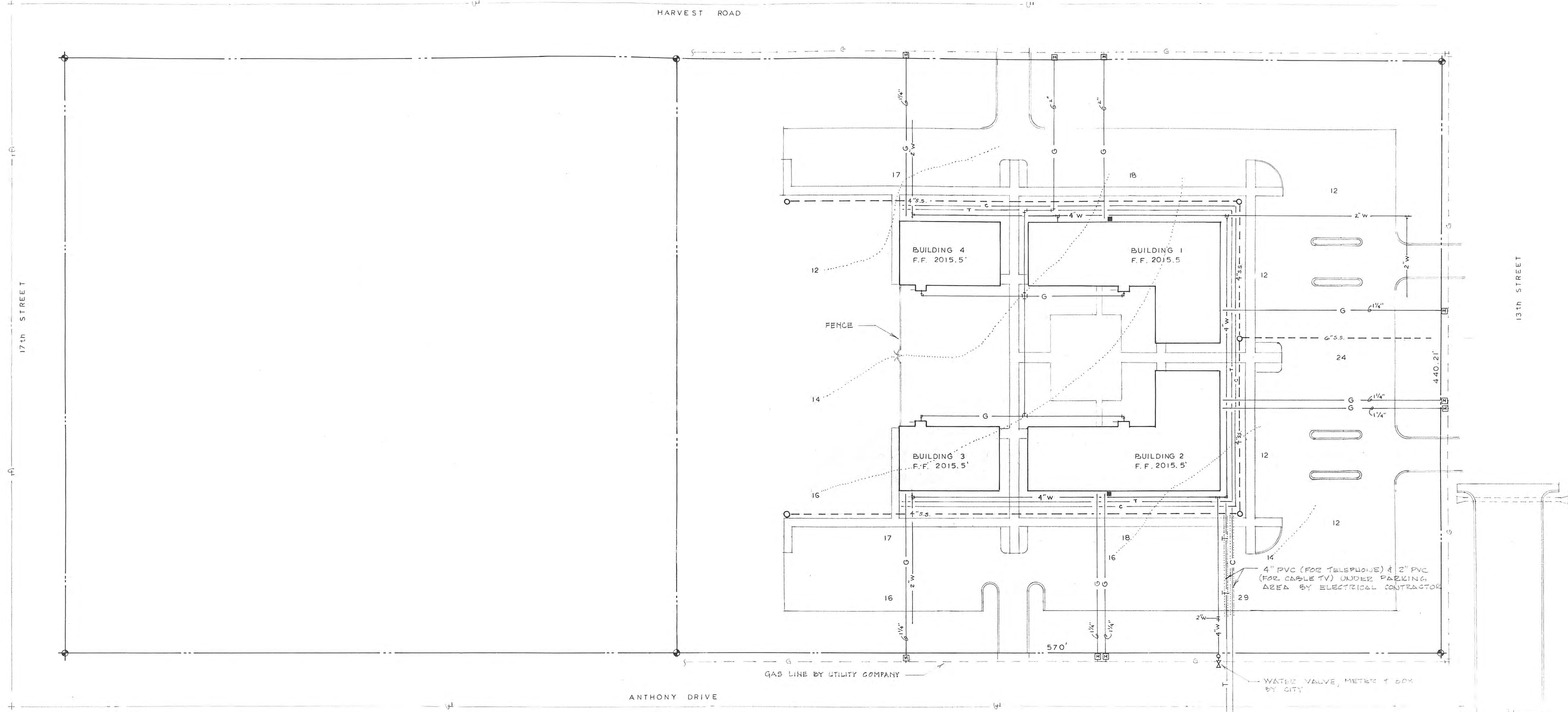

SYMBOLS

- PROPERTY LINE
- PROPERTY CORNER
- SS- SANITARY SEWER
- EXISTING CONTOUR
- NEW CONTOUR
- G- GAS LINE
- W- WATER LINE
- E- ELECTRICAL LINE
- T- TELEPHONE LINE
- GAS METER
- ④ DOOR NUMBER
- BUILDING NUMBER
- WINDOW NUMBER
- N.I.C. NOT IN CONTRACT
- EL. 15.6' NEW GRADES
- C- CABLE TV

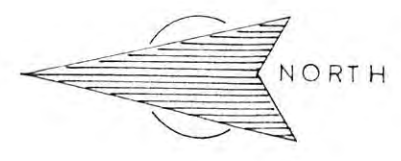

SITE PLAN
scale 1" = 40' - 0"

MATERIAL INDEX

- | | | | |
|--|------------------------|--|------------------|
| | EARTH | | WOOD |
| | SANDFILL | | STEEL |
| | CONCRETE | | RIGID INSULATION |
| | CONCRETE BLOCK | | BATT INSULATION |
| | LT. WT. CONCRETE BLOCK | | BLOWN INSULATION |
| | BRICK | | |
| | DIMENSION LUMBER | | |

OAK PARK A CONDOMINIUM

Owner WHEEL ENTERPRISES

Location HAYS, KANSAS

RALPH JOHN KELLER Architect
413 N. Pomeroy Hill City, Kansas
date 7-12-83 | job no 83-05-04

sheet
of 1 34