

SURVEYOR'S CERTIFICATE

STATE OF KANSAS } SS
COUNTY OF GEARY }

I, THE UNDERSIGNED, DO HEREBY CERTIFY THAT I AM A REGISTERED LAND SURVEYOR IN THE STATE OF KANSAS, WITH EXPERIENCE AND PROFICIENCY IN LAND SURVEYING; THAT THE HERETOFORE DESCRIBED PROPERTY WAS SURVEYED AND SUBDIVIDED BY ME OR UNDER MY SUPERVISION; THAT ALL SUBDIVISION REGULATIONS OF THE CITY OF HAYS, KANSAS, HAVE BEEN COMPLIED WITH IN THE PREPARATION OF THIS PLAT, AND THAT ALL THE MONUMENTS SHOWN HEREIN ACTUALLY EXIST AND THEIR POSITIONS ARE CORRECTLY SHOWN TO THE BEST OF MY KNOWLEDGE AND BELIEF. GIVEN UNDER MY HAND AND SEAL AT JUNCTION CITY, KANSAS, THIS 23 DAY OF August, 1999.

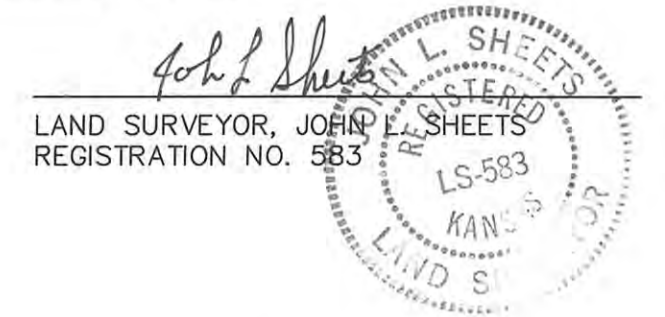

OWNER'S CERTIFICATE

STATE OF KANSAS } SS
COUNTY OF ELLIS }

KNOW ALL MEN BY THESE PRESENTS, THAT WE, THE UNDERSIGNED PROPERTY OWNERS OF THE LAND AS ABOVE SET FORTH IN THE SURVEYOR'S CERTIFICATE, HAVE CAUSED THE SAME TO BE SURVEYED AND PLATTED INTO LOTS, BLOCKS, EASEMENTS, DRIVES, A STREET AND AN AVENUE, THE SAME TO BE KNOWN AS ROTH SECOND ADDITION; THE DRIVES, STREETS, AND AVENUES ARE HEREBY DEDICATED TO AND FOR THE USE OF THE PUBLIC, AND EASEMENTS AS INDICATED ON THE ACCOMPANYING PLAT ARE HEREBY GRANTED TO THE PUBLIC FOR THE PURPOSE OF CONSTRUCTING, OPERATING, MAINTAINING, AND REPAIRING ALL PUBLIC UTILITIES.

Simon Roth, Jr., AS HIMSELF & AS ATTORNEY IN FACT FOR DOROTHY SODERBLOM PHILIP REVERMAN, SR.

OWNER'S CERTIFICATE

STATE OF KANSAS } SS
COUNTY OF } SS

KNOW ALL MEN BY THESE PRESENTS, THAT WE, THE UNDERSIGNED PROPERTY OWNERS OF THE LAND AS ABOVE SET FORTH IN THE SURVEYOR'S CERTIFICATE, HAVE CAUSED THE SAME TO BE SURVEYED AND PLATTED INTO LOTS, BLOCKS, EASEMENTS, DRIVES, A STREET AND AN AVENUE, THE SAME TO BE KNOWN AS ROTH SECOND ADDITION; THE DRIVES, STREETS, AND AVENUES ARE HEREBY DEDICATED TO AND FOR THE USE OF THE PUBLIC, AND EASEMENTS AS INDICATED ON THE ACCOMPANYING PLAT ARE HEREBY GRANTED TO THE PUBLIC FOR THE PURPOSE OF CONSTRUCTING, OPERATING, MAINTAINING, AND REPAIRING ALL PUBLIC UTILITIES.

Walmart Stores, Inc.

BASIS OF BEARINGS: N 00'12'13" W ON THE WEST LINE OF THE FINAL PLAT OF JUENEMANN FIRST ADDITION

DESCRIPTION:

A TRACT OF LAND LOCATED IN THE SOUTHEAST QUARTER OF SECTION 21, TOWNSHIP 13 SOUTH, RANGE 18 WEST OF THE 6TH PRINCIPAL MERIDIAN, ELLIS COUNTY, KANSAS AND BEING LOTS 2, 3, 4, 5, 6, 7 AND 8, BLOCK 1, A PORTION OF FRONTAGE ROAD, ADDITIONAL PUBLIC RIGHT-OF-WAY, JUENEMANN FIRST ADDITION TO THE CITY OF HAYS, ELLIS COUNTY, KANSAS AND UNPLATTED LAND, BEING DESCRIBED AS FOLLOWS: BEGINNING AT THE SOUTHWEST CORNER OF SAID LOT 2, BLOCK 1, THENCE S 00'12'13" E ON THE WEST LINE OF LOT 1, SAID JUENEMANN FIRST ADDITION AND AN EXTENSION THEREOF, A DISTANCE OF 290.64 FEET TO THE NORTHEAST CORNER OF THE REPLAT OF A PORTION OF ROTH FIRST ADDITION TO THE CITY OF HAYS, ELLIS COUNTY, KANSAS; THENCE S 89'47'47" W ON THE NORTH LINE OF SAID REPLAT OF A PORTION OF ROTH FIRST ADDITION AND THE NORTH LINE OF ROTH FIRST ADDITION TO THE CITY OF HAYS, ELLIS COUNTY, KANSAS A DISTANCE OF 520.11 FEET TO THE NORTHWEST CORNER OF SAID ROTH FIRST ADDITION; THENCE S 00'12'13" E ON THE WEST LINE OF SAID ROTH FIRST ADDITION A DISTANCE OF 398.83 FEET TO THE SOUTHWEST CORNER OF SAID ROTH FIRST ADDITION SAID POINT ALSO BEING ON THE NORTH RIGHT-OF-WAY LINE OF INTERSTATE HIGHWAY 70; THENCE N 60'59'13" W ON SAID NORTH RIGHT-OF-WAY A DISTANCE OF 237.43 FEET; THENCE N 00'12'13" W A DISTANCE OF 1391.52 FEET; THENCE N 88'55'30" E A DISTANCE OF 1127.42 FEET TO THE WEST RIGHT-OF-WAY LINE OF U.S. 183 HIGHWAY; THENCE S 00'12'13" E ON SAID WEST RIGHT-OF-WAY LINE, A DISTANCE OF 829.00 FEET; THENCE S 88'55'30" W ON THE SOUTH LINE AND EXTENSION THEREOF OF SAID LOT 2, BLOCK 1, A DISTANCE OF 400.00 FEET TO THE POINT OF BEGINNING. CONTAINS 26.836 ACRES, MORE OR LESS. SUBJECT TO EASEMENTS, RESERVATIONS AND RESTRICTIONS OF RECORD. END OF DESCRIPTION

NOTARY CERTIFICATE

STATE OF KANSAS } SS
COUNTY OF } SS

BE IT REMEMBERED THAT ON THIS 2nd DAY OF September 19 99 BEFORE ME, A NOTARY PUBLIC IN AND FOR SAID COUNTY AND STATE, CAME Robert Roth, Asst. Vice President TO BE PERSONALLY KNOWN TO BE THE SAME PERSON WHO EXECUTED THE FOREGOING INSTRUMENT OF WRITING AND DULY ACKNOWLEDGED THE EXECUTION OF SAME. IN TESTIMONY WHEREOF I HAVE HEREUNTO SET MY HAND AND AFFIXED MY NOTORIAL SEAL THE DAY AND YEAR ABOVE WRITTEN.

Sharon K. Young, Notary Public, My Commission Expires 6-12-2005

NOTARY CERTIFICATE

STATE OF KANSAS } SS
COUNTY OF } SS

BE IT REMEMBERED THAT ON THIS 14th DAY OF September 19 99 BEFORE ME, A NOTARY PUBLIC IN AND FOR SAID COUNTY AND STATE, CAME Simon Roth, Jr. TO BE PERSONALLY KNOWN TO BE THE SAME PERSON WHO EXECUTED THE FOREGOING INSTRUMENT OF WRITING AND DULY ACKNOWLEDGED THE EXECUTION OF SAME. IN TESTIMONY WHEREOF I HAVE HEREUNTO SET MY HAND AND AFFIXED MY NOTORIAL SEAL THE DAY AND YEAR ABOVE WRITTEN.

ELINDA BAUER, Notary Public - State of Kansas, My Appl. Expires 1-8-2000

Elinda Bauer, Notary Public, My Commission Expires 1-8-2000

HAYS - ELLIS COUNTY PLANNING COMMISSION CERTIFICATE

STATE OF KANSAS } SS
COUNTY OF ELLIS }

THIS PLAT OF ROTH SECOND ADDITION HAS BEEN SUBMITTED TO AND APPROVED BY THE HAYS-ELLIS COUNTY PLANNING COMMISSION THIS 16th DAY OF August, 1999.

Larry Gould, Chairman, Larry Gould; Sue Boldra, Secretary, Sue Boldra

EASEMENTS

EASEMENTS ARE HEREBY DEDICATED FOR PUBLIC USE, AS UTILITY EASEMENT RIGHT-OF-WAY WHICH ARE SHOWN AS LYING BETWEEN THE DASHED LINES IN WIDTHS INDICATED AND AS SET FORTH ON THIS PLAT UNLESS OTHERWISE NOTED, AND SAID EASEMENTS MAY BE EMPLOYED FOR THE PURPOSE OF INSTALLING, REPAIRING AND MAINTAINING GAS LINES, ELECTRIC LINES, TELEPHONE LINES, AND ALL OTHER FORMS AND TYPES OF PUBLIC UTILITIES NOW OR HEREAFTER USED BY THE PUBLIC OVER, UNDER, AND ALONG THE STRIPS MARKED "EASEMENT".

STREETS

STREETS, AVENUES, AND DRIVES SHOWN ON THIS PLAT AND NOT HERETOFORE DEDICATED TO AND FOR PUBLIC USE ARE HEREBY SO DEDICATED.

CERTIFICATE OF CITY COMMISSION

STATE OF KANSAS } SS
COUNTY OF ELLIS }

THE DEDICATIONS SHOWN ON THIS PLAT ARE HEREBY ACCEPTED BY THE CITY COMMISSION OF THE CITY OF HAYS, KANSAS THIS 27 DAY OF August, 1999.

Carol Sue Berger, City Clerk; Wayne Billinger, Mayor

THE ABOVE AND FOREGOING PLAT IS APPROVED BY THE CITY ATTORNEY OF THE CITY OF HAYS, KANSAS THIS 14 DAY OF September, 1999.

City Attorney signature

CERTIFICATE OF REGISTER OF DEEDS

STATE OF KANSAS } SS
COUNTY OF ELLIS }

THIS IS TO CERTIFY THAT THIS INSTRUMENT WAS FILED FOR RECORD IN THE REGISTER OF DEEDS OFFICE ON THE 30 DAY OF Sept 1999, AT 9:20 AND IS DULY RECORDED IN PLAT BOOK 475 AT PAGE 369.

Mary Ann Wing, Deputy Register of Deeds; Rose Ann Rupp, Register of Deeds; Alberta Klaus, County Clerk



Copy 475-605, Reel 475-694, Plat-Book 475-696

ENTERED ON TRANSFER RECORD THIS 30th DAY OF September 1999.

FINAL PLAT ROTH SECOND ADDITION

UNPLATTED LAND AND A REPLAT OF A PORTION OF JUENEMANN FIRST ADDITION TO THE CITY OF HAYS, ELLIS COUNTY, KANSAS KAW VALLEY ENGINEERING, INC. JUNCTION CITY, KANSAS 66441