

# Santa Fe Addition.

## HAYS to CITY.

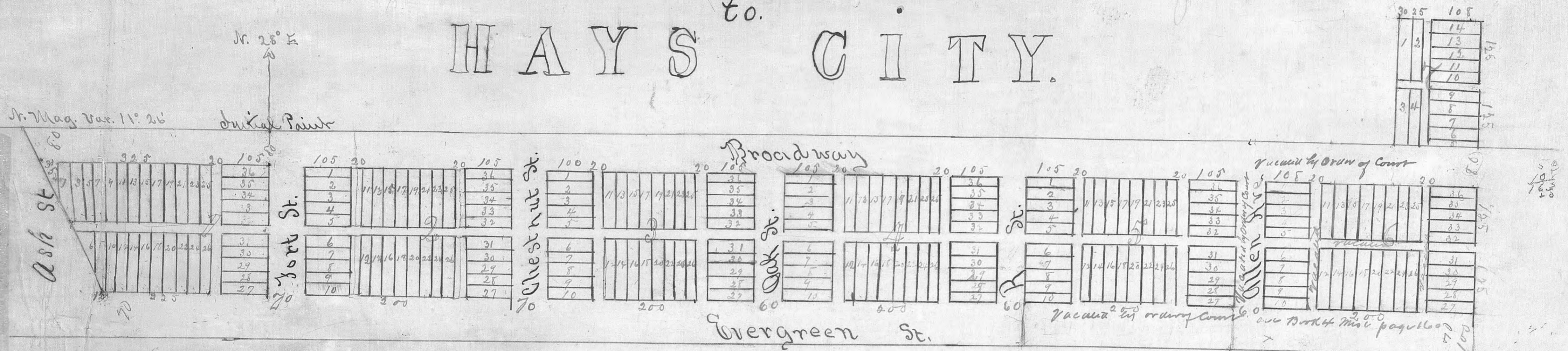

I hereby certify that the foregoing is true and correct plat of the Santa Fe Addition to Hays City Ellis County Kansas as surveyed by me and located on a part of Section No. Four (4) in township No. Fourteen (14) South of Range No. Eighteen (18) West of the first Principal Meridian and bounded and described as follows to-wit: Commencing at a point the NE corner of said Section Four which said line of Broadway of the City of Hays in intersects said line and running East 28° South along said line of Broadway 2751 feet thence North 25° East 340 feet thence East 25° South 180 feet. Thence South 25° West 720 feet. Thence West 25° North 510 feet. Thence North 25° East 100 feet thence West 25° North 450. Thence South 25° West 100 feet. Thence West 25° North to the intersection of said West line of Section No. Four. Thence North along said Section line to place of beginning. The initial point of said survey to which all distances are referred is the South East corner of Block No. Seventeen (17), of the P. Wilson Addition to Hays City now the City of Hays at the initial bench mark of the grade of said City of Hays Width of Streets and alleys and dimensions of lots and blocks are indicated by figures upon the margin

Witness my hand this Oct. 15<sup>th</sup> 1887  
Nathaniel Robbins  
Surveyor

A true copy filed for record Nov. 10<sup>th</sup> 1887  
and duly recorded in plat book. Ellis County Records

Ali C. Fox Reg  
By Ellis Ingrame Dep.

{ For Ordinance Vacating the two  
Alleys running North and South  
through blocks 2 & 3 in Santa Fe Add.  
See Miss. Record 9 Page 546. }

{ For Ordinance Vacating Part  
of Evergreen Street See Miss.  
Record "9" Page 496. }

Entered in transfer record in this  
Office of the County Clerk this 10<sup>th</sup>  
day of November A.D. 1887. on Page  
94 Book "A"

Henry Orshant  
County Clerk