

THIS IS A DIRECT PHOTOGRAPHIC REPRODUCTION OF THE OFFICIAL INSTRUMENT (RECORDED PLAT).
 THIS REPRODUCTION WAS MADE BY BUCHER & WILLIS CONSULTING ENGINEERS, PLANNERS & ARCHITECTS IN JUNE 1979

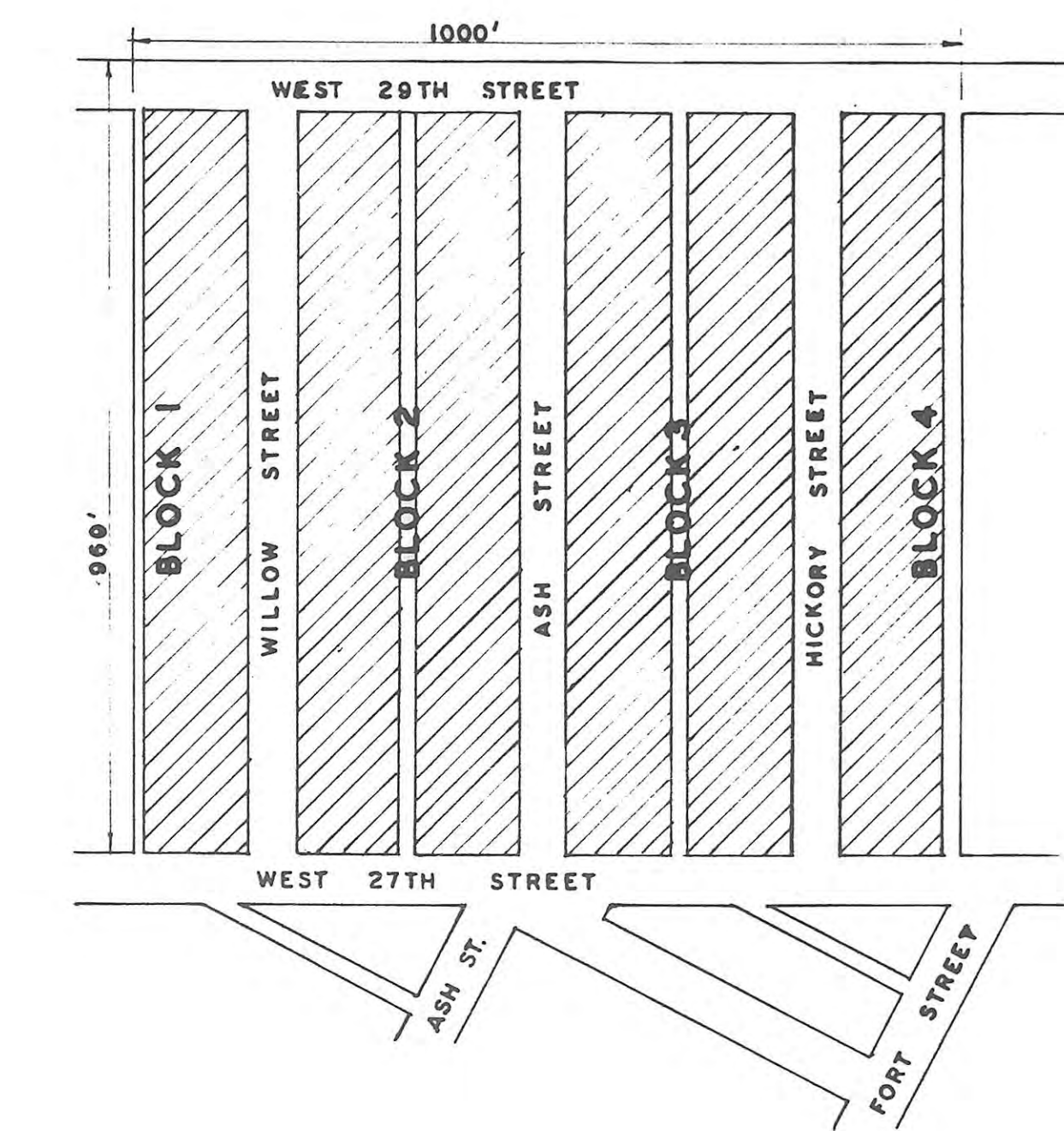

SCALE: 1" = 50'



LOCATION MAP
 SCALE: 1" = 200'

SKYLINE ADDITION

TO THE
 CITY OF HAYS'
 KANSAS

HAROLD A. ROTHGEB
 ARCHITECTURAL & ENGINEERING
 SERVICE
 HAYS KANSAS

STATE OF KANSAS
 ELLIS COUNTY
 This instrument was filed for record
 JUL 30 1955
 9:30 AM recorded in
 228-13-18 page 45
 Fees \$6.00
 8-20-22
 Register of Deeds

I CERTIFY THIS SURVEY TO BE TRUE AND CORRECT.
Harold A. Rothgeb
 HAROLD A. ROTHGEB
 LICENSED PROFESSIONAL ENGINEER

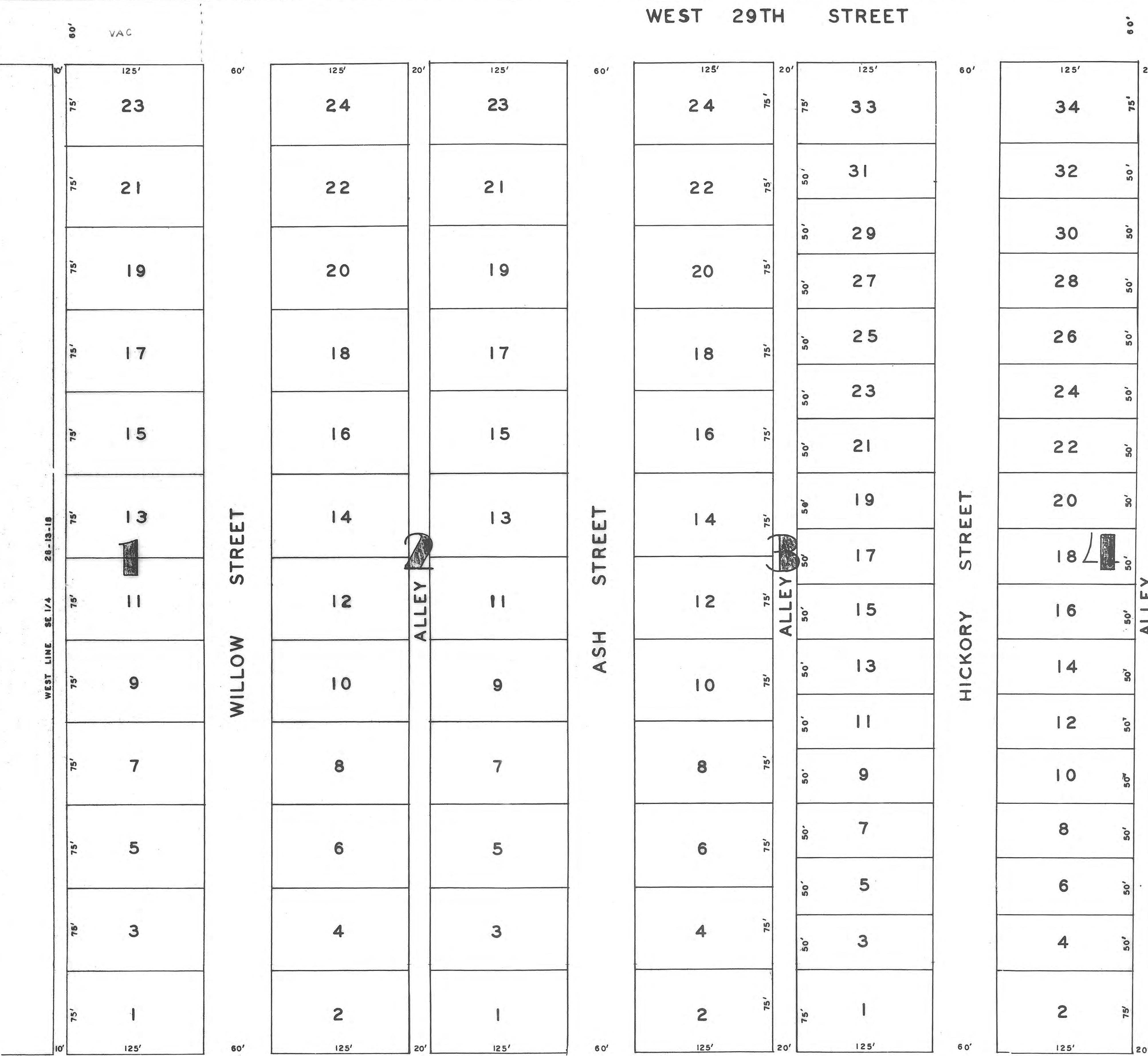

WEST 27TH STREET

472.3' 581' 286.7'

ASH STREET

FORT STREET

I hereby certify that this plat was approved by the governing body of the City of Hays, Kansas, this 18th day of July, 1955.
Harold A. Rothgeb
 City Clerk

APPROVED BY HAYS CITY PLANNING COMMISSION:
 JULY 1955
R.S. Markwell
 R.S. MARKWELL, CHAIRMAN

STATE OF KANSAS
 ELLIS COUNTY
 This instrument was filed for record
 MAR 31 1954
 8:50 AM recorded in
 228-13-18 page 45
 Fees \$6.00
 8-20-22
 Register of Deeds