

KNOW ALL MEN BY THESE PRESENTS that UNION PACIFIC RAILROAD COMPANY, a corporation organized under and by virtue of the laws of the State of Utah, in consideration of the sum of ONE AND NO/100 (\$1.00) DOLLARS, to it paid, the receipt of which is hereby acknowledged, doth hereby GRANT, REMISE, RELEASE AND WAIVER QUIT CLAIM AND CONVEY unto each of the OWNERS OF THE SEVERAL lots or parcels, respective portions of the Real Estate hereinafter described, as such owners appear of record in the Aged in Deeds, in the County of Hays, State of Kansas, at date hereof, the following parcels of real estate, to wit:

All that part of Block No. Seven (7) in C. W. Reeder's Addition to the City of Hays, in the County of Hays, Kansas, which is included between lines parallel with and distant respectively One hundred (100) feet and Two hundred (200) feet Southwesterly from the center line of the original main track of the Union Pacific Railroad Company, when measured at right angles thereto, also all that part of said City of Hays lying between the east line of Pine Street and the north line of Section Fourteen (14) South Range East, in Township Fourteen (14) South, Range East, in the County of Hays, State of Kansas, which is included between lines parallel with and distant respectively One hundred twenty-five (125) feet and Two hundred (200) feet Southwesterly and between lines parallel with and distant respectively One hundred (100) feet and Two hundred (200) feet Southwesterly from said center line of original main track, when measured at right angles thereto. Also all that part of said E. Wilson's Addition to said City lying between the east line of Pine Street and the north line of Section Fourteen (14) South, Range East, in Township Fourteen (14) South, Range East, in the County of Hays, State of Kansas, which is included between lines parallel with and distant respectively One hundred twenty-five (125) feet and Two hundred (200) feet Southwesterly and between lines parallel with and distant respectively One hundred (100) feet and Two hundred (200) feet Southwesterly from said center line of original main track, when measured at right angles thereto. Also all that part of said City of Hays lying between the east line of Pine Street and the north line of Section Fourteen (14) South, Range East, in Township Fourteen (14) South, Range East, in the County of Hays, State of Kansas, which is included between lines parallel with and distant respectively One hundred twenty-five (125) feet and Two hundred (200) feet Southwesterly and between lines parallel with and distant respectively One hundred (100) feet and Two hundred (200) feet Southwesterly from said center line of original main track, when measured at right angles thereto. Also all that part of said J. H. Wilson's Addition to said City lying between

the West line of Allen Avenue and the North and South center line of said Section Four (4), which is included between lines parallel with and distant respectively One hundred twenty-five (125) feet and Two hundred (200) feet Southwesterly from said center line of original main track, when measured at right angles thereto. Also, all that part of Blocks Nos. One (1), Two (2), and Three (3), in H. P. Wilson's Addition to said City, which is included between lines parallel with and distant respectively One hundred twenty-five (125) feet and Two hundred (200) feet Southwesterly from said center line of original main track, when measured at right angles thereto.

The tracts of land hereinabove described are shown colored in green on blue print attached hereto and marked "Exhibit A".

TO HAVE AND TO HOLD the said premises with all the rights and appurtenances thereto belonging unto the said OWNERS as hereinabove recited, grantees, their heirs and assigns forever.

IN WITNESS WHEREOF, the said Grantor, UNION PACIFIC RAILROAD COMPANY, has caused these presents to be sealed with its corporate seal, and to be signed by its Vice-President and attested by its Assistant Secretary, and countersigned by its Land Commissioner, this 5th day of March, A.D., 1916.

IN PRESENCE OF: [Signatures] UNION PACIFIC RAILROAD COMPANY, By [Signature] VICE-PRESIDENT.

ATTEST: [Signature] ASSISTANT SECRETARY. [Signature] LAND COMMISSIONER.

STATE OF NEW YORK } COUNTY OF NEW YORK } SS:

BE IT REMEMBERED, That on this 5th day of March, A.D., 1916, before me, a Notary Public, in and for said County, appeared the UNION PACIFIC RAILROAD COMPANY, by [Signature] Vice-President, who is personally known to me to be the identical person whose name is subscribed to the foregoing instrument as said Vice-President, and then and there acknowledged the execution and sealing of said instrument to be his voluntary act and deed; and the voluntary act and deed of said Company. IN WITNESS WHEREOF, I have hereunto set my hand and official seal this 5th day of March, A.D., 1916, at the City of New York, in said County and State. My Commission expires [Date].

NOTARY PUBLIC. [Signature]

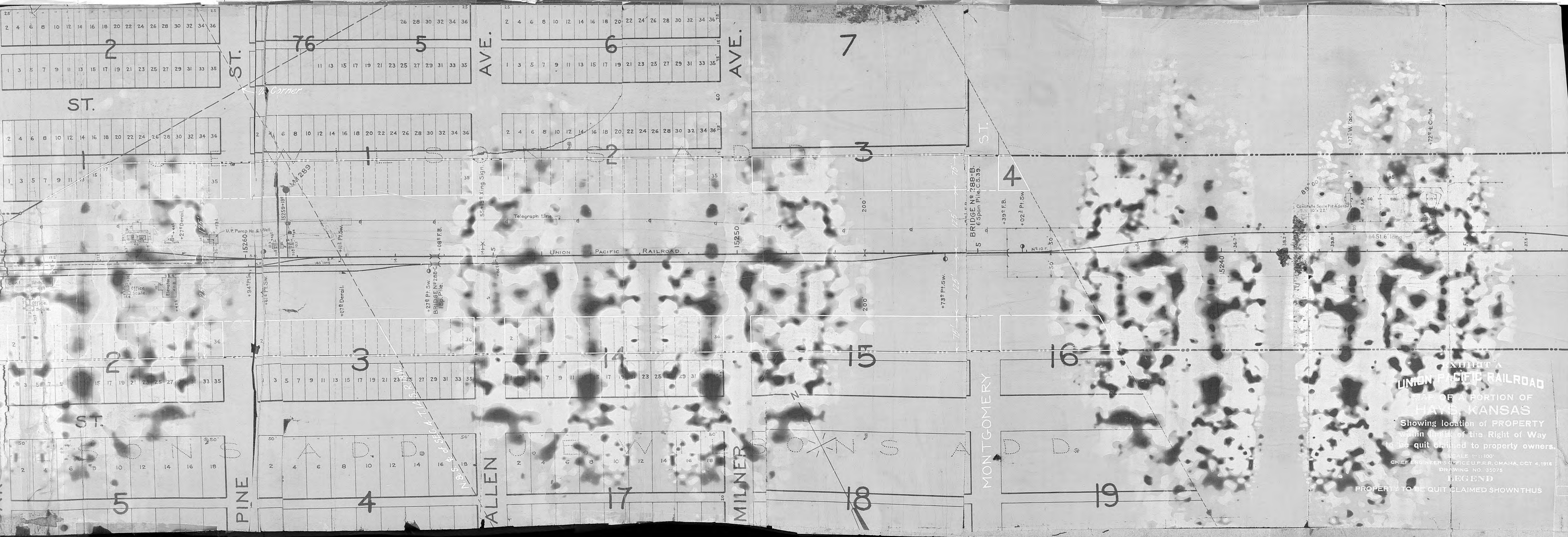

EXHIBIT A UNION PACIFIC RAILROAD A PORTION OF HAYS, KANSAS Showing location of PROPERTY within limits of the Right of Way to be quit claimed to property owners. SCALE 1"=100' CHIEF ENGINEER'S OFFICE U.P.R.R. OMAHA, OCT. 4, 1916 DRAWING NO. 33075 LEGEND PROPERTY TO BE QUIT CLAIMED SHOWN THUS