

Original Walker

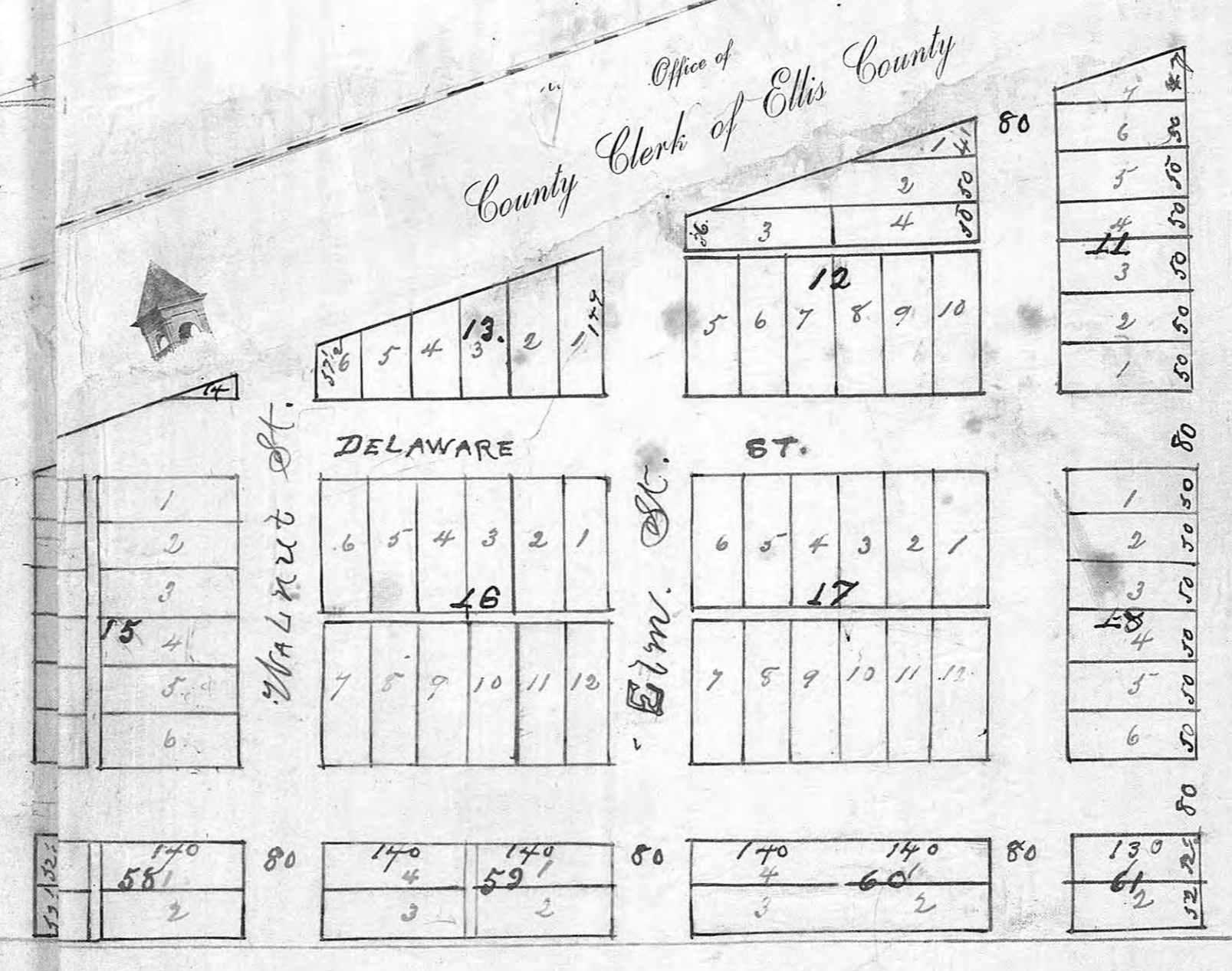

Scale 150 to the inch.

I hereby certify that I have surveyed and laid off into
 Town of blocks the North East Quarter of Sec. 3,
 Range 16, excepting 10 acres in South West Corner
 Ellis County, Kansas, also that portion of the
 24 of N.W. 1/4 of sec. 21 in same township and
 24, excepting the original plat of Walker recorded
 W. L. Shull's map, r. 12, 10" that the point of com-
 monment and from which all the lots and streets
 located in town were run 40 feet South and 50
 feet of streets and alleys and the size of lots
 2 blocks are so represented on this plat in line
 figures, scale 150 feet to the inch. The
 where at the South West corner and the
 original plat of Walker are not included in this
 plat and should not be recorded.

Richard Short Survey, Vacation Proceedings on the part south of
 1887 for record April the 8th 1887
 E. C. Cox Register of Deeds, Sec. Commissioners Record
 Book 'C' Page 53

know All Men by these presents that We
 The Walker Town and Improvement
 Company of Ellis County State of Kansas
 has caused to be Surveyed and Platted for
 Record in accordance with the Laws of the
 State of Kansas a certain portion of the
 North East Quarter of Section Number Three (3)
 in Township fourteen (14) South of Range
 Sixteen (16) West of the Sixth principal Meridian
 lying part of and adjoining the Town of
 Walker in said County of Ellis, as an
 addition to the said Town to be named
 and known as the Walker Town and Improv-
 ement Company's addition to Walker
 The Plat hereto attached being a correct
 map of the said addition showing all
 Streets, Alleys, and Public grounds, by their
 Courses, Boundaries and Extent, The
 length and width of lots intended for
 sale being indicated by figures in
 red ink in feet, and the width of all
 streets and alleys being shown in line
 manner, said map is on a scale of 150
 feet to one inch and all streets and alleys
 and public grounds as shown thereon are
 hereby forever dedicated to public use
 for the purposes indicated and for no other
 purpose.

In Testimony Whereof We have
 hereunto set our hands and affixed our
 seals this sixth day of April ad 1887

W. J. Green Secretary
 W. E. Dana President
 State of Kansas
 Ellis County
 Be it remembered that on this 6th day of
 April ad 1887. Before me a notary public
 in and for the County and State aforesaid
 Personally appeared D. E. Dana President
 of the Walker Town and Improvement
 Company and W. J. Green Secretary
 Personally known to me to be the
 President of the Walker Town and Improv-
 ement Co, who executed the foregoing Statement
 and Dedication, and the accompanying Plat
 of the Walker Town and Improvement
 Addition to Walker and acknowledged
 their signatures.

COPY
 RESOLUTION NO. 1892-21
 OF THE BOARD OF COMMISSIONERS OF ELLIS COUNTY, KANSAS
 WHEREAS, the Board of Commissioners of Ellis County, Kansas, do hereby certify that the following is a true and correct copy of the original plat of the Walker Town and Improvement Company's addition to Walker, as recorded in the official county map, and that the same shall be in force and effect from and after the date of the recording of the same in the official county map, to-wit: the 1st day of April, 1887.

COPY
 RESOLUTION NO. 1892-21
 OF THE BOARD OF COMMISSIONERS OF ELLIS COUNTY, KANSAS
 WHEREAS, the Board of Commissioners of Ellis County, Kansas, do hereby certify that the following is a true and correct copy of the original plat of the Walker Town and Improvement Company's addition to Walker, as recorded in the official county map, and that the same shall be in force and effect from and after the date of the recording of the same in the official county map, to-wit: the 1st day of April, 1887.