

RESOLUTION OF THE BOARD OF ELLIS COUNTY COMMISSIONERS... NOTICE OF VARIATION OF AN ALLEY AND STRAIGHT... PLAN OF YOCEMENTO, MILL AND GROUNDS.

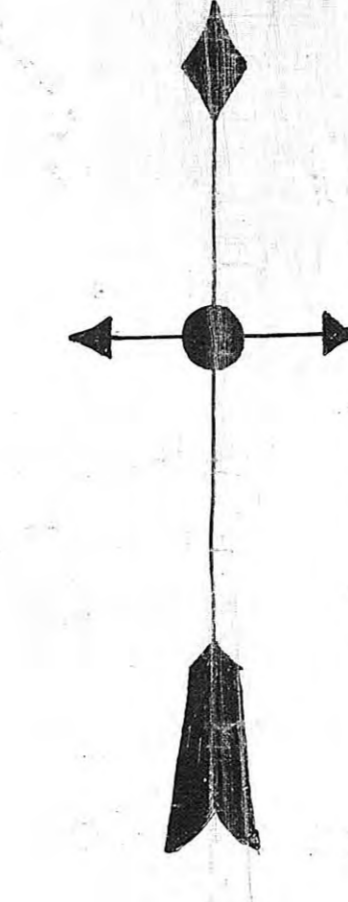

PLAN OF YOCEMENTO, MILL AND GROUNDS.

Scale 1" = 150'

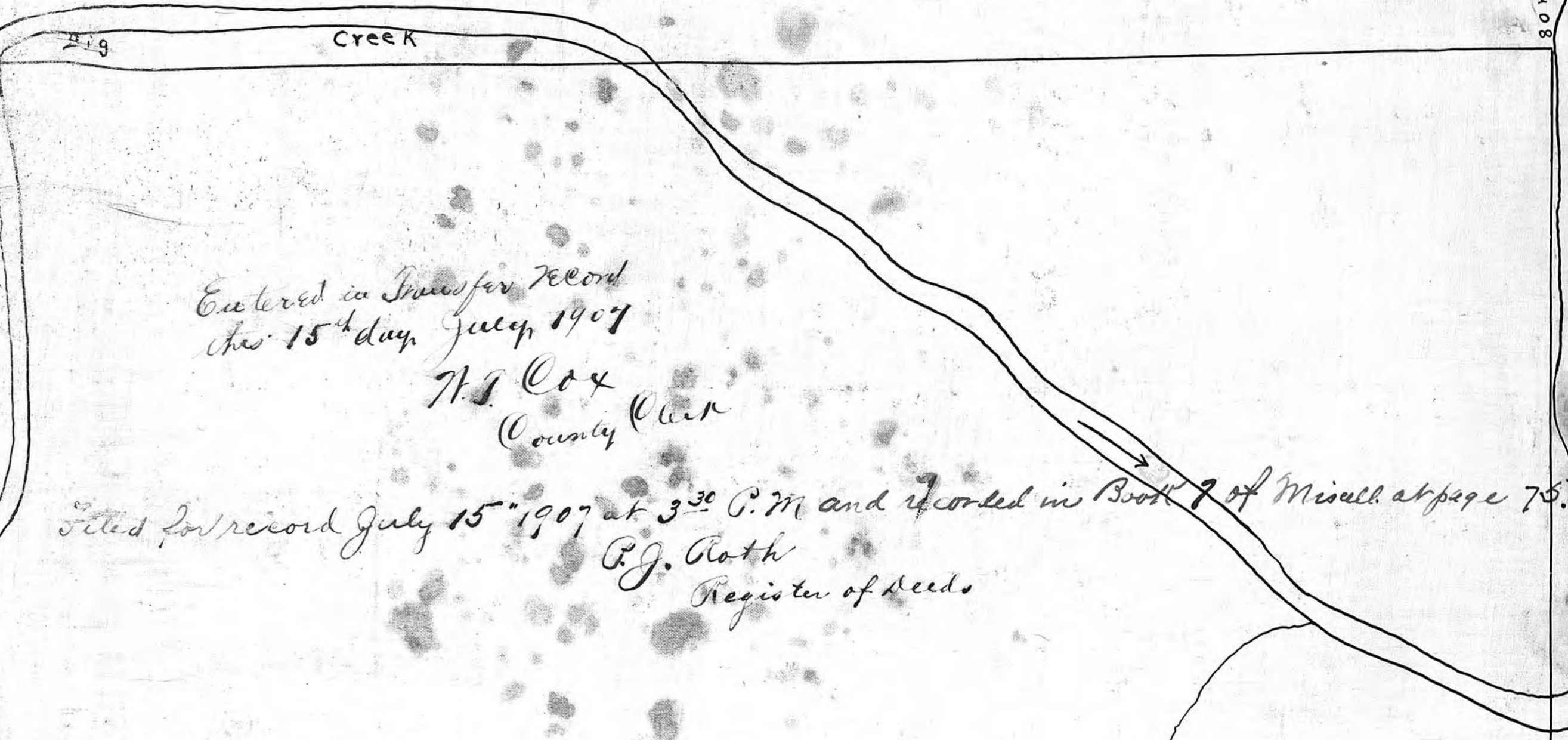

Entered in Transfer Record
Nov 15th day, July, 1907
H.S. Cox
County Clerk
Filed for record July 15th 1907 at 3:30 P.M. and recorded in Book 9 of Minell at page 75.
C.J. Roth
Register of Deeds

Know All Men by these presents that the undersigned, J. P. Hasinger, of the County of Ellis, State of Kansas, do hereby certify that the following is a true and correct copy of the plat of the above described land as shown to me by the said J. P. Hasinger, on the 11th day of July, 1907.

For Variation of Blocks & Town Lots of Yocemento, see Book 9 of Minell Page 308.
J. P. Hasinger Reg. of Deeds
Victoria Calif. sep.